

Data Bars

[G+](#) [Follow](#)

9.7k

Data bars in Excel 2010 make it very easy to visualize values in a range of cells. A longer bar represents a higher value.

To add data bars, execute the following steps.

1. Select a range.
2. On the Home tab, click Conditional Formatting, Data Bars, and click a subtype.

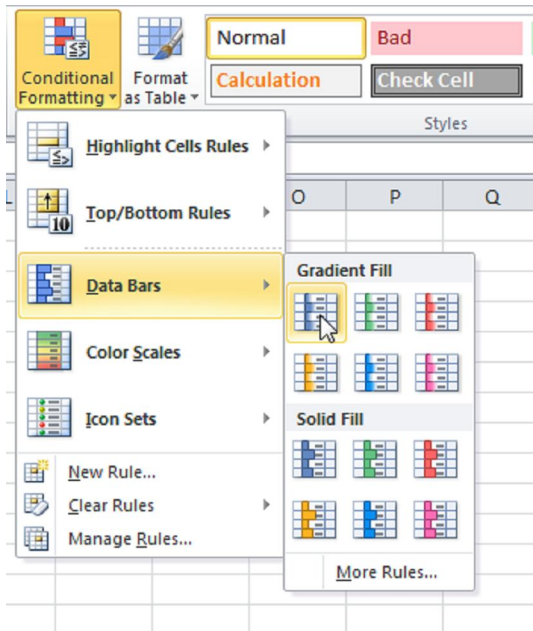

Result:

Chapter

[Conditional Formatting](#)

Learn more, it's easy

[Manage Rules](#)[Data Bars](#)[Color Scales](#)[Icon Sets](#)[New Rule](#)[Find Duplicates](#)[Shade Alternate Rows](#)[Compare Two Lists](#)[Conflicting Rules](#)[Checklist](#)

Download Excel File

[data-bars.xlsx](#)

Follow Excel Easy



	A	B
1	14	
2	6	
3	39	
4	43	
5	2	
6	95	
7	5	
8	11	
9	85	
10	57	
11		
12		

Explanation: by default, the cell that holds the minimum value (0 if there are no negative values) has no data bar and the cell that holds the maximum value (95) has a data bar that fills the entire cell. All other cells are filled proportionally.

3. Change the values.

Result. Excel updates the data bars automatically. Read on to further customize these data bars.

	A	B
1	101	
2	125	
3	137	
4	114	
5	139	
6	106	
7	127	
8	148	
9	133	
10	121	
11		
12		

4. Select the range A1:A10.

5. On the Home tab, click Conditional Formatting, [Manage Rules](#).

6. Click Edit rule.

Excel launches the Edit Formatting Rule dialog box. Here you can further customize your data bars (Show Bar Only, Minimum and Maximum, Bar Appearance, Negative Value and Axis, Bar Direction, etc).

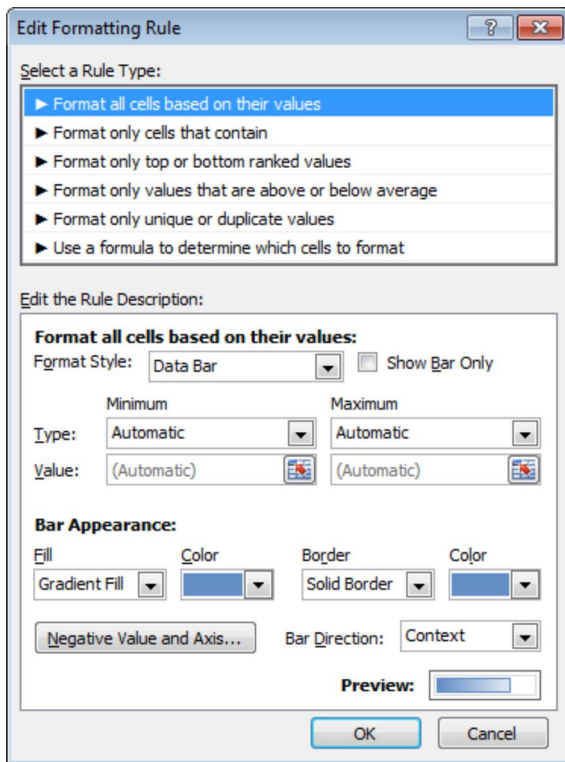

Note: to directly launch this dialog box for new rules, at step 2, click More Rules.

7. Select Number from the Minimum drop-down list and enter the value 100. Select Number from the Maximum drop-down list and enter the value 150.

8. Click OK twice.

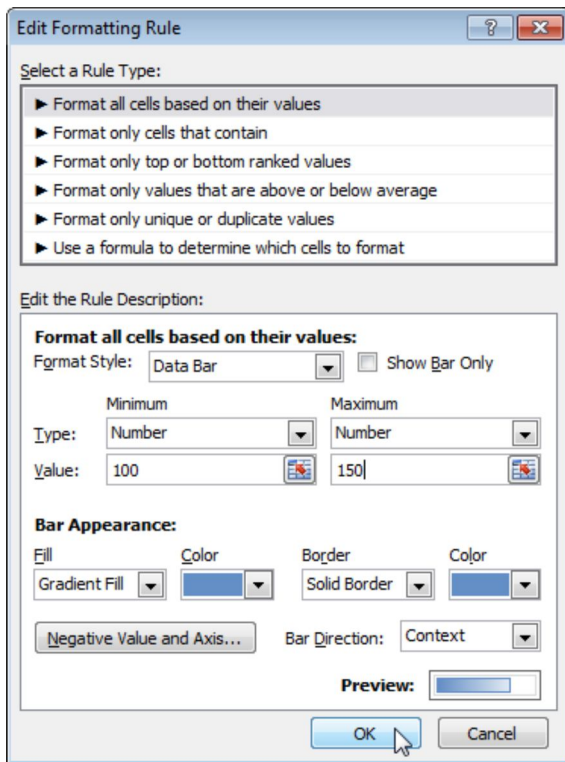

Result.

	A	B
1	101	
2	125	
3	137	
4	114	
5	139	
6	106	
7	127	
8	148	
9	133	
10	121	
11		
12		

Explanation: the cell that holds the value 100 (if any) has no data bar and the cell that holds the value 150 (if any) has a data bar that fills the entire cell. All other cells are filled proportionally.

Do you like this free website? Please follow us on Google+



[Learn more about conditional formatting, use the side menu >>](#)

Go to Top: [Data Bars](#) | Go to Next Chapter: [Charts](#)